

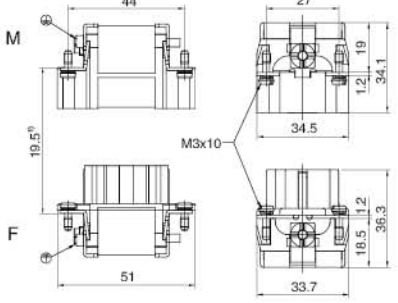
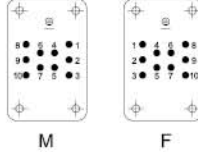

# HEE-010,HEE-018 高密度型接插体 HIGH DENSITY TYPE PLUG

额定电流 Rated current: 16 A 额定电压 Rated voltage: 500 V

接插体

	型号 Type	订货号 Part No. 公接插针 Male insert 母接插针 Female insert	尺寸图 Drawing (mm)
<p>接线方式: 冷压接 Termination methods: Crimp terminal (冷压针请单独订购 Order crimp contacts separately)</p>  <p>M F</p>	HEE-010-M	1320103001	<p>1) 接插体之间最大距离 21mm Distance for contact max. 21mm</p>  <p>接插针排序 Contact arrangement</p>  <p>M F</p>
<p>线规 Wire gauge: 0.5-4.0 mm<sup>2</sup> 适配 H6B 外壳, 详见 6.13.1 页 Suitable for H6B housing, see page 6.13.1</p>	HEE-010-F	1320103101	
<p>接线方式: 冷压接 Termination methods: Crimp terminal (冷压针请单独订购 Order crimp contacts separately)</p>  <p>M F</p>	HEE-018-M	1320183001	<p>1) 接插体之间最大距离 21mm Distance for contact max. 21mm</p>  <p>接插针排序 Contact arrangement</p>  <p>M F</p>
<p>线规 Wire gauge: 0.5-4.0 mm<sup>2</sup> 适配 H10B 外壳, 详见 6.13.4 页 Suitable for H10B housing, see page 6.13.4</p>	HEE-018-F	1320183101	

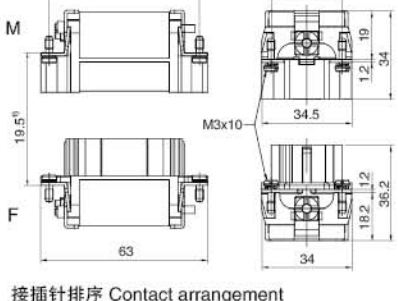
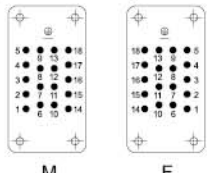
## 16A 插针 Contacts

### 技术参数 Technical data

材质: 铜镀银 / 金  
Material: Copper, hard silver / gold plated  
接触电阻 Contact resistance:  $\leq 1\text{m}\Omega$   
接线形式: 冷压接线  
Termination methods: Crimp connection

CEM



DEM



CEF



DEF



16A 公插针 Male

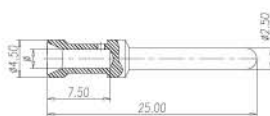

16A 母插针 Female

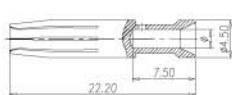

线径 (mm <sup>2</sup> ) Wire gauge	接线长度 Stripping length	镀银冷压针 Crimp contacts, silver-plated		镀金冷压针 Crimp contacts, gold-plated		
		型号 Type	订货号 Part No.	型号 Type	订货号 Part No.	
0.14-0.37	AWG26-22	7.5mm	CEM-0.37	3330006127	DEM-0.37	3330006117
0.5	AWG20	7.5mm	CEM-0.5	3330006121	DEM-0.5	3330006122
0.75	AWG18	7.5mm	CEM-0.75	3330006114	DEM-0.75	3330006115
1.0	AWG18	7.5mm	CEM-1.0	3330006105	DEM-1.0	3330006118
1.5	AWG16	7.5mm	CEM-1.5	3330006104	DEM-1.5	3330006116
2.5	AWG14	7.5mm	CEM-2.5	3330006102	DEM-2.5	3330006123
4.0	AWG12	7.5mm	CEM-4.0	3330006107	DEM-4.0	3330006119

线径 (mm <sup>2</sup> ) Wire gauge	接线长度 Stripping length	镀银冷压针 Crimp contacts, silver-plated		镀金冷压针 Crimp contacts, gold-plated		
		型号 Type	订货号 Part No.	型号 Type	订货号 Part No.	
0.14-0.37	AWG26-22	7.5mm	CEF-0.37	3330006227	DEF-0.37	3330006217
0.5	AWG20	7.5mm	CEF-0.5	3330006221	DEF-0.5	3330006222
0.75	AWG18	7.5mm	CEF-0.75	3330006214	DEF-0.75	3330006215
1.0	AWG18	7.5mm	CEF-1.0	3330006205	DEF-1.0	3330006218
1.5	AWG16	7.5mm	CEF-1.5	3330006204	DEF-1.5	3330006216
2.5	AWG14	7.5mm	CEF-2.5	3330006202	DEF-2.5	3330006223
4.0	AWG12	7.5mm	CEF-4.0	3330006207	DEF-4.0	3330006219

# HEE-032,HEE-046 高密度型接插体 HIGH DENSITY TYPE PLUG

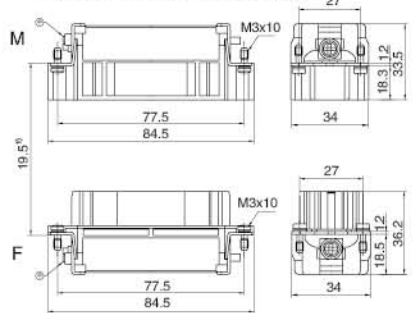
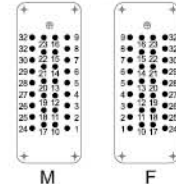
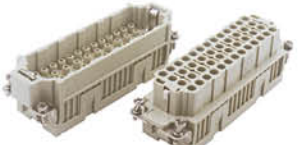
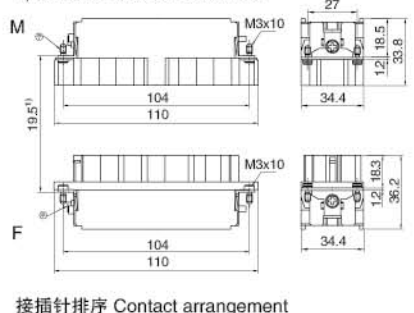
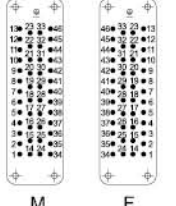

额定电流 Rated current: 16 A 额定电压 Rated voltage: 500 V

		型号 Type	订货号 Part No.		尺寸图 Drawing (mm)
			公接插针 Male insert	母接插针 Female insert	
<p>接线方式: 冷压接 Termination methods: Crimp terminal (冷压针请单独订购 Order crimp contacts separately)</p>  <p>M F</p>	HEE-032-M	1320323001		<p>1) 接插体之间最大距离 21mm Distance for contact max. 21mm</p>  <p>接插针排序 Contact arrangement</p>  <p>M F</p>	
	<p>线规 Wire gauge: 0.5-4.0 mm<sup>2</sup> 适配 H16B 外壳, 详见 6.13.10 页 Suitable for H16B housing, see page 6.13.10</p>	HEE-032-F			1320323101
<p>接线方式: 冷压接 Termination methods: Crimp terminal (冷压针请单独订购 Order crimp contacts separately)</p>  <p>M F</p>	HEE-046-M	1320463001		<p>1) 接插体之间最大距离 21mm</p>  <p>接插针排序 Contact arrangement</p>  <p>M F</p>	
	<p>线规 Wire gauge: 0.5-4.0 mm<sup>2</sup> 适配 H24B 外壳, 详见 6.13.16 页 Suitable for H24B housing, see page 6.13.16</p>	HEE-046-F			1320463101

接插体

## 16A 插针 Contacts

### 技术参数 Technical data

材质: 铜镀银 / 金  
Material: Copper, hard silver / gold plated  
接触电阻 Contact resistance:  $\leq 1m\Omega$   
接线形式: 冷压接线  
Termination methods: Crimp connection

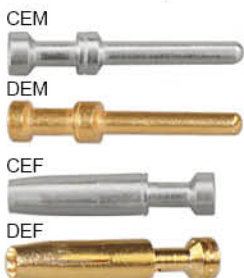

16A 公插针 Male

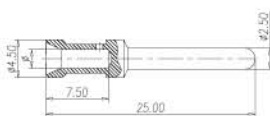

16A 母插针 Female

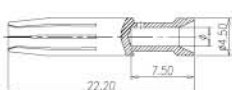



线径 (mm <sup>2</sup> ) Wire gauge	接线长度 Stripping length	镀银冷压针 Crimp contacts, silver-plated 型号 Type	订货号 Part No.	镀金冷压针 Crimp contacts, gold-plated 型号 Type	订货号 Part No.
0.14-0.37	AWG26-22 7.5mm	CEM-0.37	3330006127	DEM-0.37	3330006117
0.5	AWG20 7.5mm	CEM-0.5	3330006121	DEM-0.5	3330006122
0.75	AWG18 7.5mm	CEM-0.75	3330006114	DEM-0.75	3330006115
1.0	AWG18 7.5mm	CEM-1.0	3330006105	DEM-1.0	3330006118
1.5	AWG16 7.5mm	CEM-1.5	3330006104	DEM-1.5	3330006116
2.5	AWG14 7.5mm	CEM-2.5	3330006102	DEM-2.5	3330006123
4.0	AWG12 7.5mm	CEM-4.0	3330006107	DEM-4.0	3330006119

线径 (mm <sup>2</sup> ) Wire gauge	接线长度 Stripping length	镀银冷压针 Crimp contacts, silver-plated 型号 Type	订货号 Part No.	镀金冷压针 Crimp contacts, gold-plated 型号 Type	订货号 Part No.
0.14-0.37	AWG26-22 7.5mm	CEF-0.37	3330006227	DEF-0.37	3330006217
0.5	AWG20 7.5mm	CEF-0.5	3330006221	DEF-0.5	3330006222
0.75	AWG18 7.5mm	CEF-0.75	3330006214	DEF-0.75	3330006215
1.0	AWG18 7.5mm	CEF-1.0	3330006205	DEF-1.0	3330006218
1.5	AWG16 7.5mm	CEF-1.5	3330006204	DEF-1.5	3330006216
2.5	AWG14 7.5mm	CEF-2.5	3330006202	DEF-2.5	3330006223
4.0	AWG12 7.5mm	CEF-4.0	3330006207	DEF-4.0	3330006219

# HEE-064,HEE-092 高密度型接插体 HIGH DENSITY TYPE PLUG

额定电流 Rated current: 16 A 额定电压 Rated voltage: 500 V

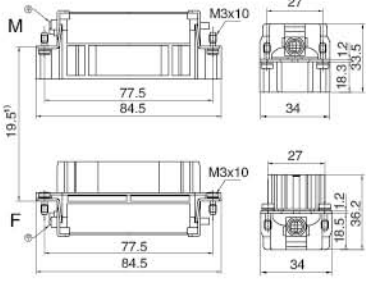
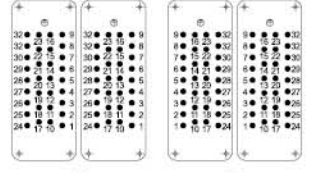
接插体

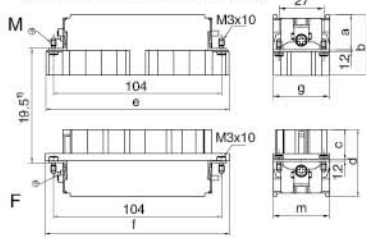
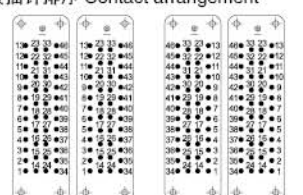
	型号 Type	订货号 Part No.		尺寸图 Drawing (mm)																											
		公接插针 Male insert	母接插针 Female insert																												
<p>接线方式: 冷压接 Termination methods: Crimp terminal (冷压针请单独订购 Order crimp contacts separately)</p>  <p>M F</p> <p>线规 Wire gauge: 0.5-4.0 mm<sup>2</sup> 适配 H32B 外壳, 详见 6.13.22 页 Suitable for H32B housing, see page 6.13.22</p>	<p>HEE-032-M (1-32) HEE-032-MD (33-64)</p>	<p>1320323001 1320323011</p>		<p>1) 接插体之间最大距离 21mm Distance for contact max. 21mm</p>  <p>接插针排序 Contact arrangement</p>  <p>M F</p>																											
<p>接线方式: 冷压接 Termination methods: Crimp terminal (冷压针请单独订购 Order crimp contacts separately)</p>  <p>M F</p> <p>线规 Wire gauge: 0.5-4.0 mm<sup>2</sup> 适配 H48B 外壳, 详见 6.13.24 页 Suitable for H48B housing, see page 6.13.24</p>	<p>HEE-046-M (1-46) HEE-046-MD (47-92)</p>	<p>1320463001 1320463011</p>		<p>1) 接插体之间最大距离 21mm</p>  <p>接插针排序 Contact arrangement</p>  <p>M F</p> <table border="1"> <thead> <tr> <th></th> <th>a</th> <th>b</th> <th>e</th> <th>g</th> <th>c</th> <th>d</th> <th>f</th> <th>m</th> </tr> </thead> <tbody> <tr> <td>M/F</td> <td>18.5</td> <td>33.8</td> <td>110.5</td> <td>34.4</td> <td>18.3</td> <td>36.2</td> <td>110</td> <td>34.4</td> </tr> <tr> <td>MD/FD</td> <td>18.3</td> <td>33.8</td> <td>110</td> <td>34.4</td> <td>18.2</td> <td>36.2</td> <td>110</td> <td>34.4</td> </tr> </tbody> </table>		a	b	e	g	c	d	f	m	M/F	18.5	33.8	110.5	34.4	18.3	36.2	110	34.4	MD/FD	18.3	33.8	110	34.4	18.2	36.2	110	34.4
	a	b	e	g	c	d	f	m																							
M/F	18.5	33.8	110.5	34.4	18.3	36.2	110	34.4																							
MD/FD	18.3	33.8	110	34.4	18.2	36.2	110	34.4																							

## 16A 插针 Contacts

技术参数 Technical data

材质: 铜镀银 / 金  
Material: Copper, hard silver / gold plated  
接触电阻 Contact resistance: ≤ 1mΩ  
接线形式: 冷压接线  
Termination methods: Crimp connection

CEM



DEM



CEF



DEF



16A 公插针 Male

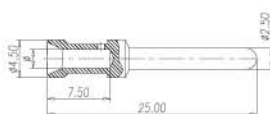

16A 母插针 Female

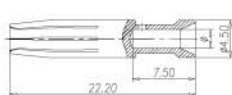

线径 (mm <sup>2</sup> ) Wire gauge	接线长度 Stripping length	镀银冷压针 Crimp contacts, silver-plated			镀金冷压针 Crimp contacts, gold-plated		
		型号 Type	订货号 Part No.	型号 Type	订货号 Part No.		
0.14-0.37	AWG26-22	7.5mm	CEM-0.37	3330006127	DEM-0.37	3330006117	
0.5	AWG20	7.5mm	CEM-0.5	3330006121	DEM-0.5	3330006122	
0.75	AWG18	7.5mm	CEM-0.75	3330006114	DEM-0.75	3330006115	
1.0	AWG18	7.5mm	CEM-1.0	3330006105	DEM-1.0	3330006118	
1.5	AWG16	7.5mm	CEM-1.5	3330006104	DEM-1.5	3330006116	
2.5	AWG14	7.5mm	CEM-2.5	3330006102	DEM-2.5	3330006123	
4.0	AWG12	7.5mm	CEM-4.0	3330006107	DEM-4.0	3330006119	

线径 (mm <sup>2</sup> ) Wire gauge	接线长度 Stripping length	镀银冷压针 Crimp contacts, silver-plated			镀金冷压针 Crimp contacts, gold-plated		
		型号 Type	订货号 Part No.	型号 Type	订货号 Part No.		
0.14-0.37	AWG26-22	7.5mm	CEF-0.37	3330006227	DEF-0.37	3330006217	
0.5	AWG20	7.5mm	CEF-0.5	3330006221	DEF-0.5	3330006222	
0.75	AWG18	7.5mm	CEF-0.75	3330006214	DEF-0.75	3330006215	
1.0	AWG18	7.5mm	CEF-1.0	3330006205	DEF-1.0	3330006218	
1.5	AWG16	7.5mm	CEF-1.5	3330006204	DEF-1.5	3330006216	
2.5	AWG14	7.5mm	CEF-2.5	3330006202	DEF-2.5	3330006223	
4.0	AWG12	7.5mm	CEF-4.0	3330006207	DEF-4.0	3330006219	