

HEEE-040,HEEE-064,HEEE-072 接插体 INSERTS

额定电流 Rated current: 16 A 额定电压 Rated voltage: 400 V

	型号 Type	订货号 Part No.		尺寸图 Drawing (mm)
		公接插针 Male insert	母接插针 Female insert	
接线方式: 冷压接 Termination methods: Crimp terminal (冷压针请单独订购 Order crimp contacts separately)	HEEE-040-M	1320403001		1) 接插体之间最大距离 21mm Distance for contact max. 21mm
	HEEE-040-F		1320403101	
接线方式: 冷压接 Termination methods: Crimp terminal (冷压针请单独订购 Order crimp contacts separately)	HEEE-064-M	1320643001		1) 接插体之间最大距离 21mm Distance for contact max. 21mm
	HEEE-064-F		1320643101	
接线方式: 冷压接 Termination methods: Crimp terminal (冷压针请单独订购 Order crimp contacts separately)	HEEE-072-M	1320723001		1) 接插体之间最大距离 21mm Distance for contact max. 21mm
	HEEE-072-F		1320723101	

接插体

16A 插针 Contacts

技术参数 Technical data

材质: 铜镀银 / 金
 Material: Copper, hard silver / gold plated
 接触电阻 Contact resistance: $\leq 1\text{m}\Omega$
 接线形式: 冷压接线
 Termination methods: Crimp connection

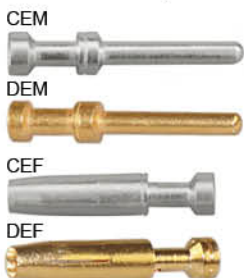

16A 公插针 Male

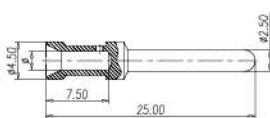

16A 母插针 Female

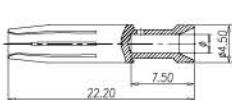

线径 (mm ²) Wire gauge	接线长度 Stripping length	镀银冷压针 Crimp contacts, silver-plated		镀金冷压针 Crimp contacts, gold-plated	
		型号 Type	订货号 Part No.	型号 Type	订货号 Part No.
0.14-0.37	AWG26-22 7.5mm	CEM-0.37	3330006127	DEM-0.37	3330006117
0.5	AWG20 7.5mm	CEM-0.5	3330006122	DEM-0.5	3330006122
0.75	AWG18 7.5mm	CEM-0.75	3330006114	DEM-0.75	3330006115
1.0	AWG18 7.5mm	CEM-1.0	3330006105	DEM-1.0	3330006118
1.5	AWG16 7.5mm	CEM-1.5	3330006104	DEM-1.5	3330006116
2.5	AWG14 7.5mm	CEM-2.5	3330006102	DEM-2.5	3330006123
4.0	AWG12 7.5mm	CEM-4.0	3330006107	DEM-4.0	3330006119

线径 (mm ²) Wire gauge	接线长度 Stripping length	镀银冷压针 Crimp contacts, silver-plated		镀金冷压针 Crimp contacts, gold-plated	
		型号 Type	订货号 Part No.	型号 Type	订货号 Part No.
0.14-0.37	AWG26-22 7.5mm	CEF-0.37	3330006227	DEF-0.37	3330006217
0.5	AWG20 7.5mm	CEF-0.5	3330006221	DEF-0.5	3330006222
0.75	AWG18 7.5mm	CEF-0.75	3330006214	DEF-0.75	3330006215
1.0	AWG18 7.5mm	CEF-1.0	3330006205	DEF-1.0	3330006218
1.5	AWG16 7.5mm	CEF-1.5	3330006204	DEF-1.5	3330006216
2.5	AWG14 7.5mm	CEF-2.5	3330006202	DEF-2.5	3330006223
4.0	AWG12 7.5mm	CEF-4.0	3330006207	DEF-4.0	3330006219